

DEBURRING TOOLS FOR SLOTTING ATTACHMENTS OF B&S AND SWISS MACHINES

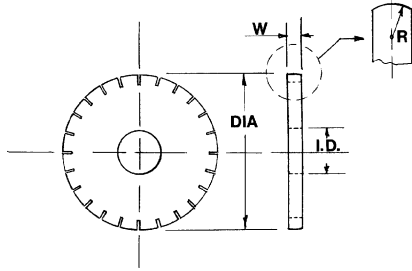

These high speed steel circular deburring tools fit the slotting attachment of B&S Screw Machines and Swiss Machines and remove cut-off burrs from the back end of the part completely, smoothly and uniformly.

The O.D. of the deburring tool is slightly crowned and the teeth are radial (without clearance) so as to only remove the cut-off burr without digging into the part.

CAT. NO.	MACHINE SIZE	DIA.	I.D.	WIDTH
SBT-00	#00 B&S	1-3/4	5/8	3/16
SBT-0	#0 B&S	2-1/4	5/8	3/16
SBT-2	#2 B&S	2-3/4	3/4	1/4
SBT-SW	SWISS	25MM(1")	8MM(.315)	3/16

BORING BAR SLEEVES

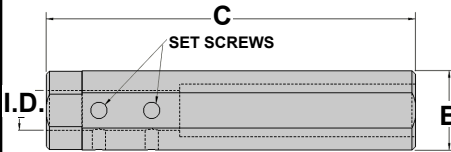

B O.D.	C Length	I.D. Size / Cat. No.																
		1/4	5/16	3/8	1/2	5/8	3/4	7/8	1"	1-1/4	1-1/2	1-3/4	2"	2-1/2				
3/4	5"	53339	53400	53392	53393													
22MM	5"	53340	53341	53342	53343	53344												
1"	6"			53401	53402													
1-1/2	7"			53411	53412	53413	53414											
1-1/2	8"							53415	53416									
1-3/4	8"					53421	53422	53422	53426	53423								
2"	9"						53431	53432	53433	53434	53435							
2-1/2	10"						53441	53442		53443	53444	53445						
3"	11-1/2"									53450	53451	53452	53455	53453	53454			
4"	14"											53460	53461	53462	53463			

TAPER DRILL SOCKETS SUPERIOR DESIGN/PREMIUM QUALITY

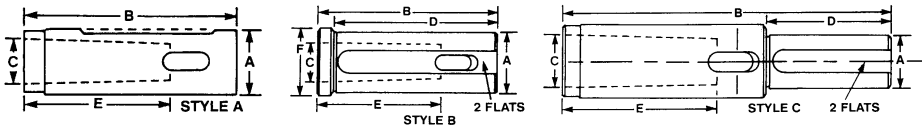

These taper drill sockets are hardened, precision ground, and concentric within .0002 of an inch. They fit directly into tool holders and turrets to positively drive all morse taper shank tools, drills, reamers, and counterbores.

The straight shank style "A" taper drill sockets are manufactured in limited quantities and sizes. Please contact our courteous sales staff for availability and pricing information. Select the O.D. size that fits your machine and order from the chart below.

CAT. NO.	STYLE	SHANK DIA. A	B	MORSE TAPER C	D	E	F
MT1-0075	A	3/4	3-1/4	No. 1	2.313	2-3/16	1
*MT1-1000	B	1	3-3/4	No. 1	3.125	2-3/16	1-1/4
*MT2-1000	B	1	3-3/4	No. 2	3.125	2-5/8	1-1/4
*MT1-1250	B	1-1/4	4	No. 1	3.375	2-3/16	1-1/2
*MT2-1250	B	1-1/4	4	No. 2	3.375	2-5/8	1-1/2
*MT3-1250	B	1-1/4	4	No. 3	4.000	3-1/4	1-1/2
*MT1-1500	B	1-1/2	5	No. 1	4.375	2-3/16	1-3/4
*MT2-1500	B	1-1/2	5	No. 2	4.375	2-5/8	1-3/4
*MT3-1500	B	1-1/2	5	No. 3	4.375	3-1/4	1-3/4
*MT4-1500	B	1-1/2	5-3/4	No. 4	4.375	4-1/8	1-3/4
*MT1-1750	B	1-3/4	5-3/4	No. 1	5.125	2-3/16	2
*MT2-1750	B	1-3/4	5-3/4	No. 2	5.125	2-5/8	2
*MT3-1750	B	1-3/4	5-3/4	No. 3	5.125	3-1/4	2
*MT4-1750	B	1-3/4	5-3/4	No. 4	4.375	4-1/8	2

* Item available in style "A". Call for price and availability.

CAT. NO.	STYLE	SHANK DIA. A	B	MORSE TAPER C	D	E	F
MT5-1750	C	1-3/4	11-1/8	No. 5	4-1/4	5-1/4	2-3/8
MT2-2000	B	2	6-1/8	No. 2	5-1/2	2-5/8	2-1/4
MT3-2000	B	2	6-1/8	No. 3	5-1/2	3-1/4	2-1/4
MT4-2000	B	2	6-1/8	No. 4	5-1/2	4-1/8	2-1/4
MT5-2000	C	2	11-1/8	No. 5	4-1/4	5-1/4	2-3/8
MT2-2500	B	2-1/2	5-3/4	No. 2	5-1/8	2-5/8	2-3/4
MT3-2500	B	2-1/2	6-5/8	No. 3	6	3-1/4	2-3/4
MT4-2500	B	2-1/2	6-5/8	No. 4	6	4-1/8	2-3/4
MT5-2500	B	2-1/2	7-5/8	No. 5	7	5-1/4	2-3/4
MT4-3000	B	3	6-5/8	No. 4	6	4-1/8	3-3/8
MT5-3000	B	3	7-5/8	No. 5	7	5-1/4	3-3/8
MT4-2250	B	2-1/4	6-5/8	No. 4	6	4-1/8	2-1/2
MT5-2250	B	2-1/4	7-5/8	No. 5	7	5-1/4	2-1/2
MT4-2750	B	2-3/4	6-5/8	No. 4	6	4-1/8	3
MT5-2750	B	2-3/4	7-5/8	No. 5	7	5-1/4	3

MISC.