

INTERCHANGEABLE WITH UNIVERSAL ENGINEERING ACURA-FLEX* STYLE COLLETS

• ALSO AVAILABLE WITH SEALED SLOTS
FOR UP TO 650 PSI COOLANT FEED.



Collet Chucks for these holders are
available on request.

1/64 COLLAPSE RANGE PER COLLET

Collet Series	A	B
AF25	.438	1.000
AF38	.563	1.030
AF50	.720	1.160
AF75	1.130	2.020
AF100	1.446	2.500

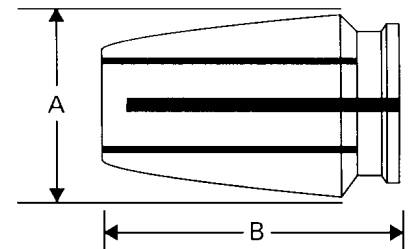

COLLET SETS

Cat. No.	Collet Series	Contents of Collets Sets
AF25-SET	AF25	12 COLLETS-1/16 TO 1/4 BY 1/64 INCREMENTS
AF38-SET	AF38	20 COLLETS-1/16 TO 3/8 BY 1/64 INCREMENTS
AF50-SET	AF50	25 COLLETS-7/64 TO 1/2 BY 1/64 INCREMENTS
AF75-1SET	AF75	42 COLLETS-7/64 TO 3/4 BY 1/64 INCREMENTS
AF75-2SET	AF75	21 COLLETS-1/8 TO 3/4 BY 1/32 INCREMENTS
AF75-3SET	AF75	11 COLLETS-1/8 TO 3/4 BY 1/16 INCREMENTS
AF100-1SET	AF100	51 COLLETS-7/32 TO 1" BY 1/64 INCREMENTS
AF100-2SET	AF100	26 COLLETS-7/32 TO 1" BY 1/32 INCREMENTS
AF100-3SET	AF100	13 COLLETS-1/4 TO 1" BY 1/16 INCREMENTS

*ACURA-FLEX IS A REGISTERED TRADEMARK OF UNIVERSAL ENGINEERING.

Bore	Series AF100 Cat. No.	Series AF75 Cat. No.	Series AF50 Cat. No.	Series AF38 Cat. No.	Series AF25 Cat. No.
5/64				AF38-5/64	AF25-5/64
3/32				AF38-3/32	AF25-3/32
7/64		AF75-7/64	AF50-7/64	AF38-7/64	AF25-7/64
3MM				AF38-3	AF25-3
1/8		AF75-1/8	AF50-1/8	AF38-1/8	AF25-1/8
9/64		AF75-9/64	AF50-9/64	AF38-9/64	AF25-9/64
5/32		AF75-5/32	AF50-5/32	AF38-5/32	AF25-5/32
11/64		AF75-11/64	AF50-11/64	AF38-11/64	AF25-11/64
3/16		AF75-3/16	AF50-3/16	AF38-3/16	AF25-3/16
5MM		AF75-5	AF50-5	AF38-5	AF25-5
13/64	AF100-13/64	AF75-13/64	AF50-13/64	AF38-13/64	AF25-13/64
7/32	AF100-7/32	AF75-7/32	AF50-7/32	AF38-7/32	AF25-7/32
15/64	AF100-15/64	AF75-15/64	AF50-15/64	AF38-15/64	AF25-15/64
1/4	AF100-1/4	AF75-1/4	AF50-1/4	AF38-1/4	AF25-1/4
17/64	AF100-17/64	AF75-17/64	AF50-17/64	AF38-17/64	
7MM	AF100-7	AF75-7	AF50-7	AF38-7	
9/32	AF100-9/32	AF75-9/32	AF50-9/32	AF38-9/32	
19/64	AF100-19/64	AF75-19/64	AF50-19/64	AF38-19/64	
5/16	AF100-5/16	AF75-5/16	AF50-5/16	AF38-5/16	
21/64	AF100-21/64	AF75-21/64	AF50-21/64	AF38-21/64	
11/32	AF100-11/32	AF75-11/32	AF50-11/32	AF38-11/32	
9MM	AF100-9	AF75-9	AF50-9	AF38-9	
23/64	AF100-23/64	AF75-23/64	AF50-23/64	AF38-23/64	
3/8	AF100-3/8	AF75-3/8	AF50-3/8	AF38-3/8	
25/64	AF100-25/64	AF75-25/64	AF50-25/64		
13/32	AF100-13/32	AF75-13/32	AF50-13/32		
27/64	AF100-27/64	AF75-27/64	AF50-27/64		
7/16	AF100-7/16	AF75-7/16	AF50-7/16		
29/64	AF100-29/64	AF75-29/64	AF50-29/64		
15/32	AF100-15/32	AF75-15/32	AF50-15/32		
31/64	AF100-31/64	AF75-31/64	AF50-31/64		
1/2	AF100-1/2	AF75-1/2	AF50-1/2		
33/64	AF100-33/64	AF75-33/64			
17/32	AF100-17/32	AF75-17/32			
35/64	AF100-35/64	AF75-35/64			
9/16	AF100-9/16	AF75-9/16			
37/64	AF100-37/64	AF75-37/64			
19/32	AF100-19/32	AF75-19/32			
39/64	AF100-39/64	AF75-39/64			
5/8	AF100-5/8	AF75-5/8			
41/64	AF100-41/64	AF75-41/64			
21/32	AF100-21/32	AF75-21/32			
43/64	AF100-43/64	AF75-43/64			
11/16	AF100-11/16	AF75-11/16			
45/64	AF100-45/64	AF75-45/64			
23/32	AF100-23/32	AF75-23/32			
47/64	AF100-47/64	AF75-47/64			
3/4	AF100-3/4	AF75-3/4			
49/64	AF100-49/64	AF75-49/64			
25/32	AF100-25/32	AF75-25/32			
51/64	AF100-51/64				
13/16	AF100-13/16				
53/64	AF100-53/64				
27/32	AF100-27/32				
55/64	AF100-55/64				
7/8	AF100-7/8				
57/64	AF100-57/64				
29/32	AF100-29/32				
59/64	AF100-59/64				
15/16	AF100-15/16				
61/64	AF100-61/64				
31/32	AF100-31/32				
63/64	AF100-63/64				
1	AF100-1				