

CAT 50 STRAIGHT SHANK ADAPTERS

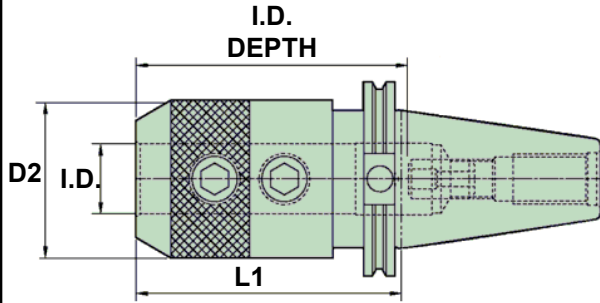

I.D.	COLLET CHUCK PART #	I.D. DEPTH	D2	L1
1"	CV50SS100400	3-3/4"	2-1/4"	4"
1"	CV50SS100600	3-3/4"	2-1/4"	6"
1"	CV50SS100800	3-3/4"	2-1/4"	8"
1-1/4"	CV50SS125400	3-1/4"	2-1/4"	4"
1-1/4"	CV50SS125600	3-1/4"	2-1/4"	6"
1-1/4"	CV50SS125800	3-1/4"	2-1/4"	8"
1-1/2"	CV50SS150400	3-1/4"	2-3/4"	4"
1-1/2"	CV50SS150600	3-1/4"	2-3/4"	6"
1-1/2"	CV50SS150800	3-1/4"	2-3/4"	8"
1-3/4"	CV50SS175400	2-3/4"	3.13"	4"
2"	CV50SS200562	3-1/4"	3.69"	5.62"
2"	CV50SS200762	3-1/4"	3.69"	7.62"
2-1/2"	CV50SS250800	4-1/4"	4"	8"

V-FLANGE COLLET CHUCKS

CAT 50 WITH COOLANT THROUGH THE FLANGE

I.D.	COLLET CHUCK PART #	I.D. DEPTH	D2	L1
3/4"	CV50BSSF075275	2-1/4"	1-3/4"	2-3/4"
1"	CV50BSSF100400	3-1/4"	2"	4"
1-1/4"	CV50BSSF125400	3-1/2"	2-1/2"	4"
1-1/2"	CV50BSSF150450	4"	2-3/4"	4-1/2"
2"	CV50BSSF200550	4-1/4"	3-3/4"	5-1/2"

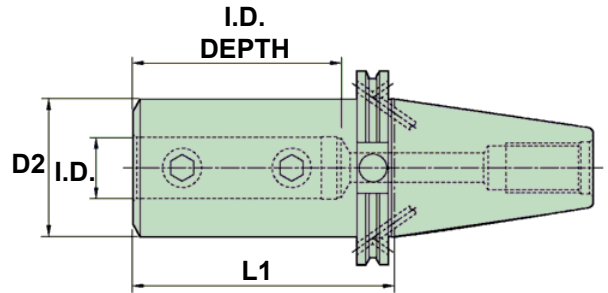

CAT 40 WITH COOLANT THROUGH THE FLANGE

I.D.	COLLET CHUCK PART #	I.D. DEPTH	D2	L1
3/4"	CV40BSSF075275	2-1/4"	1-3/4"	2-3/4"
1"	CV40BSSF100450	3-1/4"	2"	4-1/2"
1"	CV40SS100400	3-3/4"	2-1/4"	4"
1-1/4"	CV40BSSF125475	3-1/2"	2-1/2"	4-3/4"
1-1/2"	CV40BSSF150575	4"	2-3/4"	5-3/4"



HSK SHANK TOOL HOLDERS



A complete line of HSK shank tool holders is available in sizes 40, 50, 63, 80 & 100 forms A, C & E.

Its features include rigidity and positioning accuracy. In comparison to steep taper tooling, higher cutting speeds/revolutions are possible with HSK tooling.

HSK enjoys a good reputation in higher speed and high precision machining applications on machining centers, multi-spindle machines and transfer lines. It is also gaining popularity in the automotive, aerospace, and component industries.

Please call with your requirements.

