

CAT. NO.	A	B
DTG-250	1/2	.185
DTG-250 x 100	13/32	.100

**SOLD AS A SET  
2 PIECES**

### DOVETAIL CHECKING GAGES

- EASIER THAN CHECKING OVER BALLS OR RODS.
- JUST ADD .500" TO THEORETICAL SHARP CORNER DIMENSION OF DOVETAIL. (SEE DIAGRAM.)

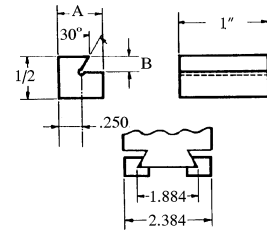

### EDM WIRE READY H.S.S. BARS

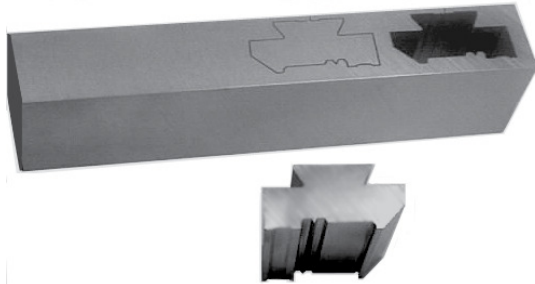

**ASK FOR QUANTITY  
DISCOUNT PRICES FOR  
GREATER SAVINGS**

- HEAT TREATED / SURFACE GROUND
- FOR THOSE WHO HAVE WIRE EDM EQUIPMENT
- ECONOMICAL - MINIMUM WASTE
- USE ONLY WHAT YOU NEED FOR EACH JOB
- AVAILABLE IN M2, M42, T15PM AND 76PM HIGH SPEED STEEL

HEIGHT	WIDTH	LENGTH	M2 CAT. NO.	M42 CAT. NO.	T15PM CAT. NO.	76PM CAT. NO.
1"	2"	12"	EDM4848	EDM4848-H	EDM4848-P	EDM4848-A
1-1/2"	2"	12"	EDM6848	EDM6848-H	EDM6848-P	EDM6848-A
2"	2"	12"	EDM8848	EDM8848-H	EDM8848-P	EDM8848-A
2"	2-1/2"	12"	EDM81248	EDM81248-H	EDM81248-P	EDM81248-A

**CAN ALSO BE SUPPLIED IN  
SPECIAL SIZES TO YOUR  
SPECIFICATIONS. PRICES ON  
APPLICATION - SPECIFY  
QUANTITY, HEIGHT, WIDTH  
AND LENGTH.**

### DOVETAIL SHARPENING FIXTURES FOR 12° AND 17° ANGLES



Dovetail Size	Cat. No.
5/8" (.951)	DSF-5/8
1-1/4" (1.882)	DSF-1-1/4

*One side of the fixture for grinding 12° angle dovetails  
and the opposite side for 17° angle dovetails*

### ADJUSTABLE DOVETAIL SHARPENING FIXTURE

**Cat. No.  
DSF**

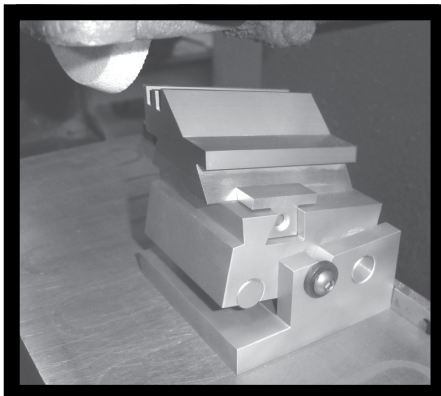

- CAN BE USED IN BOTH VERTICAL AND HORIZONTAL POSITIONS
- FOR DOVETAIL SIZES UP TO 1.882 (1-1/4)
- SUPPLIED WITH SPACERS FOR THE FOLLOWING ANGLES:  
0, 2, 12, 17, 19.5 & 22 DEGREES

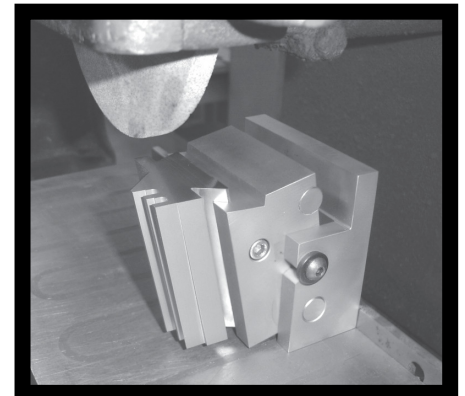

**CAN ALSO SUPPLY SPACERS FOR OTHER ANGLES**