

B&S CIRCULAR FORM TOOL BLANKS

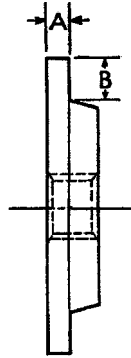

* Flange type (cutaway blanks)
save grinding time on narrow tools.

ALL BLANKS ARE AVAILABLE WITH PIN HOLES TO THE FOLLOWING SPECIFICATIONS				
Mach. Size	No. of Holes	Dia.	Depth	Bolt Circle
#00 B&S	8	5/32	5/16	1-1/16
#00 TRAUB	8	1/8	5/16	.787
#0 B&S	6	3/16	5/16	1-3/8
#2 B&S	6	3/16	3/8	1-1/2

*Specify type when ordering #00 Blanks.
PRICES ON APPLICATION FOR THRU HOLES OR ANY VARIATION OF THESE SPECIFICATIONS.

- Hardened and Surface ground both sides
- O.D. turned only

WIDTH		M2	M42	T15PM	76PM
A	B	CAT. NO.	CAT. NO.	CAT. NO.	CAT. NO.
#00 B&S		1-3/4" Dia.		3/8-16 Tap Hole	
.080	7/32	00FLH08	00FLH08H	00FLH08P	00FLH08A
.120	1/4	00FLH12	00FLH12H	00FLH12P	00FLH12A
.160	1/4	00FLH16	00FLH16H	00FLH16P	00FLH16A
.200	1/4	00FLH20	00FLH20H	00FLH20P	00FLH20A
1/4		00BH8	00BH8H	00BH8P	00BH8A
5/16		00BH10	00BH10H	00BH10P	00BH10A
3/8		00BH12	00BH12H	00BH12P	00BH12A
7/16		00BH14	00BH14H	00BH14P	00BH14A
1/2		00BH16	00BH16H	00BH16P	00BH16A
9/16		00BH18	00BH18H	00BH18P	00BH18A
5/8		00BH20	00BH20H	00BH20P	00BH20A
3/4		00BH24	00BH24H	00BH24P	00BH24A
7/8		00BH28	00BH28H	00BH28P	00BH28A
1"		00BH32	00BH32H	00BH32P	00BH32A
1-1/8		00BH36	00BH36H	00BH36P	00BH36A
1-1/4		00BH40	00BH40H	00BH40P	00BH40A
1-3/8		00BH44	00BH44H	00BH44P	00BH44A
1-1/2		00BH48	00BH48H	00BH48P	00BH48A
1-5/8		00BH52	00BH52H	00BH52P	00BH52A
1-3/4		00BH56	00BH56H	00BH56P	00BH56A

WIDTH		M2	M42	T15PM	76PM
A	B	CAT. NO.	CAT. NO.	CAT. NO.	CAT. NO.
#2 B&S		3" Dia		5/8-11 Tap Hole	
1/8	3/8	2FLH4	2FLH4H	2FLH4P	2FLH4A
3/16	1/2	2FLH6	2FLH6H	2FLH6P	2FLH6A
1/4	1/2	2FLH8	2FLH8H	2FLH8P	2FLH8A
5/16	1/2	2FLH10	2FLH10H	2FLH10P	2FLH10A
3/8		2BH12	2BH12H	2BH12P	2BH12A
7/16		2BH14	2BH14H	2BH14P	2BH14A
1/2		2BH16	2BH16H	2BH16P	2BH16A
9/16		2BH18	2BH18H	2BH18P	2BH18A
5/8		2BH20	2BH20H	2BH20P	2BH20A
3/4		2BH24	2BH24H	2BH24P	2BH24A
7/8		2BH28	2BH28H	2BH28P	2BH28A
1"		2BH32	2BH32H	2BH32P	2BH32A
1-1/8		2BH36	2BH36H	2BH36P	2BH36A
1-1/4		2BH40	2BH40H	2BH40P	2BH40A
1-3/8		2BH44	2BH44H	2BH44P	2BH44A
1-1/2		2BH48	2BH48H	2BH48P	2BH48A
1-5/8		2BH52	2BH52H	2BH52P	2BH52A
1-3/4		2BH56	2BH56H	2BH56P	2BH56A
1-7/8		2BH60	2BH60H	2BH60P	2BH60A
2"		2BH64	2BH64H	2BH64P	2BH64A
2-1/4		2BH72	2BH72H	2BH72P	2BH72A
2-1/2		2BH80	2BH80H	2BH80P	2BH80A
2-3/4		2BH88	2BH88H	2BH88P	2BH88A
3"		2BH96	2BH96H	2BH96P	2BH96A
3-1/4		2BH104	2BH104H	2BH104P	2BH104A
3-1/2		2BH112	2BH112H	2BH112P	2BH112A
3-3/4		2BH120	2BH120H	2BH120P	2BH120A
4"		2BH128	2BH128H	2BH128P	2BH128A

WIDTH		M2	M42	T15PM	76PM
A	B	CAT. NO.	CAT. NO.	CAT. NO.	CAT. NO.
#0 B&S		2-1/4" Dia.		1/2-13 Tap Hole	
.100	1/4	0FLH10	0FLH10H	0FLH10P	0FLH10A
.150	3/8	0FLH15	0FLH15H	0FLH15P	0FLH15A
.200	3/8	0FLH20	0FLH20H	0FLH20P	0FLH20A
.250	3/8	0FLH25	0FLH25H	0FLH25P	0FLH25A
5/16		0BH10	0BH10H	0BH10P	0BH10A
3/8		0BH12	0BH12H	0BH12P	0BH12A
7/16		0BH14	0BH14H	0BH14P	0BH14A
1/2		0BH16	0BH16H	0BH16P	0BH16A
9/16		0BH18	0BH18H	0BH18P	0BH18A
5/8		0BH20	0BH20H	0BH20P	0BH20A
3/4		0BH24	0BH24H	0BH24P	0BH24A
7/8		0BH28	0BH28H	0BH28P	0BH28A
1"		0BH32	0BH32H	0BH32P	0BH32A
1-1/8		0BH36	0BH36H	0BH36P	0BH36A
1-1/4		0BH40	0BH40H	0BH40P	0BH40A
1-3/8		0BH44	0BH44H	0BH44P	0BH44A
1-1/2		0BH48	0BH48H	0BH48P	0BH48A
1-5/8		0BH52	0BH52H	0BH52P	0BH52A
1-3/4		0BH56	0BH56H	0BH56P	0BH56A
1-7/8		0BH60	0BH60H	0BH60P	0BH60A
2"		0BH64	0BH64H	0BH64P	0BH64A

SEE NEXT PAGE FOR SOLID CARBIDE BLANKS

BLANKS FOR B&S CIRCULAR POINTING TOOLS

- M2 H.S.S. - Hardened
- I.D. and Both Sides Ground
- O.D. Turned



MACH. SIZE	O.D.	WIDTH	I.D.	CAT. NO.
#00 B&S	1-1/8	1/4	3/8	00PTBL
#0 B&S	1-3/8	3/8	3/8	0PTBL
#2 B&S	1-3/4	1/2	1/2	2PTBL