

Somma

TOOL COMPANY, INC.

**PREMIER TOOLING FOR THE
MANUFACTURING INDUSTRY**

since 1939

TITLE	PAGE	TITLE	PAGE
Broaching, Internal		Reaming	
Swiss Adjustment Free Broach Tool Holders.....	8	ER Collet Floating Reamer Holder	113
Swiss Broaching Heads for ER Collet Chucks	7	DA Collet Floating Reamer Holder	114
Adjustable Broach Tool Holders	10	Bushing Style Adjustable Offset Holder.....	115
CNC Adj. Free Broach Tool Holders	11	VDI Shank ER Collet Floating Reamer Holder.....	114
Index Punch Broaching	17	Morse Taper Shank ER Collet Holder.....	115
Driven Broach Tool Holder for Multi's	11	Solid Carbide Reamers	116-117
Broaches 8mm Dia x 28mm (#SW).....	9	Swiss Mini Shank Tooling	
Broaches: 8mm Dia. x 1-1/4" (#00)	12-14	Series 6 Holders & Diamond Inserts	57-63
Broaches: 1/2" Dia. x 1-3/4" (#2).....	12-14	Series 8 Holders & Diamond Inserts	65,66,76
Broaches: 3/4" Dia. x 2-3/4" (#HD).....	15 & 16	Series 50 Holders & Diamond Inserts	67-69
Gages; Set Up & Go / No Go	16	Series 10 Holders & Triangular Inserts.....	70-71
Broaching, External		Series 16 Holders & Triangular Inserts.....	72-73
External Broach Tool Holders	18	Series 20 Holders & Triangular Inserts.....	74-75
Driven Broach Tool Holder for Multi's	11	Forming & Shaving	
External Broaches	19	RQC Quick Change Resharpenable	20-29
Drilling		Form & Shave Tool System	
Davenport and B&S Drill Holders	118-119	STAI Economical Quick Change	30
Quick Change ER Collet System	120-123	Form Tool System	
ER Collet, Collet Chucks	124-128	Form Tool Calculation Program.....	31
ER Collet Double Ended Collet Chucks	129	Spindle Speed/Surface Feet Calculator	31
DA & TG Collet, Collet Chucks	130-132	Dovetail Form Tool Holders	32-33
Automotive Threaded Shank Collet Chuck	119	Dovetail Form Tool Blanks.....	34-35
Drill Speeder & Air Speeder	133	Dovetail Shave Tool Blanks	36
Solid Carbide Drills	134-138	Dovetail Checking Gages.....	35
Flat Drill Blanks	139	Dovetail Sharpening Fixtures	35
Drill Blanks	139	Davenport Circ. Tools & Holders	38-39
End Working		B&S Circ. Form Tool Holder	40
Davenport Countersink.....	86	B&S Circ. Blanks and Form Tools	41-44
Countersinking	85-90	B&S Universal Tool Post	45
Spot Drilling	84	Rectangular & Square Form Tool Blanks	45
Recess Tool Holders & Tool Blanks	101	Box Turning	
Tube End Forming Tooling	91-93	Tangi-Square Insert Box Turning.....	78-79
Outside Deburring & Chamfering	94-97	Triangular Insert Box Turning	80-81
Inside Deburring & Chamfering	98-99	H.S.S. Tool Bit Box Turning	80-81
Tapping		Rectangular Insert L.H. Box Turning	80-81
Tapping / Re-Tapping 2nd Operation Mach.....	106-107	Carbide Insert Tool Bit for L.H. Turning	77
Tension / Compression & Tension Only.....	108-109	R&L Turning Tools	82-83
ER Collet Tap Holders		Replacement Rolls & Pins.....	77
Non-Releasing Tap Holders.....	110	Endmills	
Releasing Tap Holders	111-112	Solid Carbide.....	181-185
Releasing Acorn Die Holders	112		

TITLE	PAGE	TITLE	PAGE
Cutting-Off		Collets / Tool Holding	
Davenport & B&S Circ. C/O	46-47	ER8 to ER50 Drill Collets	156-160
C/O Blade Holders	47	ER11 to ER40 Tap Collets	161
T-Type C/O Blades	48-50	Erickson® "DA" Drill Collets	162-163
Acme C/O Blades	50	50TG to 150TG Drill Collets	164-167
Johnson Hollow Ground C/O Blades.....	51	50TG to 150TG Tap Collets.....	168
Twin Tip, Empire Style.....	50	Universal® Acura-Flex Drill Collets	155
Square Shank Holders W/ Indexable Inserts	52-53	Universal® Double Taper Drill Collets	161
Dav. & B&S Circ. Indexable Square Insert C/O.....	55	Sandvik® /Balas "C" Series Drill & Tap Collets	169
Indexable Square C/O Inserts	54	5C Collets	170-171
Dav. Circ. Resharpenable Insert C/O Hldr.....	55	R8 Collets	171
Knurling		Bushings / Tool Holding	
Davenport Knurling Tools	102	Split Drill Bushings	142-144
Self Centering Straddle Knurl Tools.....	102	Split Tap Bushings	145
Adjustable Straddle Knurl Tools.....	103	B&S Slotting Bushings	145
Swiss In-Line & T Style Straddle Knurl Tools	104	Type "B" Tool Holder Bushings.....	146-151
Bump Style Single Knurl Tools	105	Type "C" Tool Holder Bushings.....	151
Knurls	102	Type "DD" & "L" Tool Holder Bushings	152
Taper Shank Tooling		Type "LB" & "LBF" Tool Holder Bushings.....	153
Cat. 40 "TG" Collet Chucks	173	Type "J" & "Z" Tool Holder Bushings.....	154
Cat. 40 "ER" & "DA" Collet Chucks	174	Boring Bar Sleeves.....	141
Cat. 40 Balanced Precision Chuck.....	176	Taper Drill Sockets	141
Cat. 40 Straight Shank Adapter.....	177	Workholding	
Cat. 40 Milling Chuck	178	Bar Pullers.....	186-187
Cat. 40 Endmill Adapter.....	179	Balas Master Collets, Master Pushers	188-191
Cat. 50 "ER" & "DA" Collet Chucks	174	& Pads for Warner & Swasey Machines	
Cat. 50 "TG" Collet Chucks	175	Swiss Machine Spindle Collets	192-193
Cat. 50 Balanced Precision Chuck.....	176	Swiss Carbide Lined Guide Bushings	194
Cat. 50 Straight Shank Adapter.....	177	Miscellaneous B&S	
Cat. 50 Milling Chuck	178	Cam Blanks	140
Cat. 50 Endmill Adapter.....	179	Cam Roller & Pins	140
BT40 & 50 Precision & Milling Chucks	178	Deburring Tool for Slotting Attachments	141

Customer Service

109 Scott Road Waterbury, CT 06705 USA
(203)-753-2114 • Fax (203)-756-5489
Email: sales@sommatool.com

Your local Somma distributor will provide you with prompt service and knowledgeable assistance. We also offer excellent backup support from our factory. Here is a list of people to contact at Somma Tool Company for sales and technical assistance.

SALES / SALES ENGINEERS				BROACHING/ TECHNICAL SUPPORT		QC INSERT TOOLING/ TECHNICAL SUPPORT	
NAME	Ext.#	NAME	Ext.#	NAME	Ext.#	NAME	Ext.#
Matt Ciullo	105	Gina Somma	104	Dick Noti	108	Rob Somma	111
Jerry Somma	106	Raphael Santiago	107	Abel Rodrigues	110	Rick Grante	115

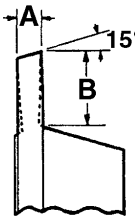

- For straight cutting-off
- **Carbide tipped tools** are supplied for right hand cutting, for left hand cutting add -L to the part number listed. All other choices have a "U" shaped gash for cutting in either direction.
- Side clearance ground
- Available with side pinholes
- Available with 23 degree C/O angle for non-ferrous metals
- Available with TIN and other coatings

CIRCULAR PLAIN CUT-OFF TOOLS FOR #0 B&S (1-3/4" DIA., 1/4" WIDE WITH 3/8-16 THREAD)

A	B	M2 PART#	T15PM PART#	3-LIP C2 CARB. TIPPED PART#	C2 SOLID CARBIDE PART#
.030	1/8	00P3	00P3V	00P3-CT	
.040	3/16	00P4	00P4V	00P4-CT	00P4-SC
.050	7/32	00P5	00P5V	00P5-CT	
.060	1/4	00P6	00P6V	00P6-CT	00P6-SC
.070	1/4	00P7	00P7V	00P7-CT	
.080	1/4	00P8	00P8V	00P8-CT	00P8-SC
.100	1/4	00P10	00P10V	00P10-CT	00P10-SC

CIRCULAR PLAIN CUT-OFF TOOLS FOR #0 B&S (2-1/4" DIA., 5/16" WIDE WITH 1/2-13 THREAD)

A	B	M2 PART#	T15PM PART#	3-LIP C2 CARB. TIPPED PART#	C2 SOLID CARBIDE PART#
.040	3/16	0P4	0P4V	0P4-CT	
.050	7/32	0P5	0P5V	0P5-CT	
.060	1/4	0P6	0P6V	0P6-CT	0P6-SC
.070	5/16	0P7	0P7V	0P7-CT	
.080	5/16	0P8	0P8V	0P8-CT	0P8-SC
.090	3/8	0P9	0P9V	0P9-CT	
.100	3/8	0P10	0P10V	0P10-CT	0P10-SC
.120	3/8	0P12	0P12V	0P12-CT	0P12-SC

CIRCULAR PLAIN CUT-OFF TOOLS FOR #2 B&S (3" DIA., 3/8" WIDE WITH 5/8-11 THREAD)

A	B	M2 PART#	T15PM PART#	3-LIP C2 CARB. TIPPED PART#	C2 SOLID CARBIDE PART#
.060	5/16	2P6	2P6V	2P6-CT	
.080	7/16	2P8	2P8V	2P8-CT	2P8-SC
.100	9/16	2P10	2P10V	2P10-CT	2P10-SC
.120	5/8	2P12	2P12V	2P12-CT	2P12-SC
.140	11/16	2P14	2P14V	2P14-CT	2P14-SC

CUT OFF

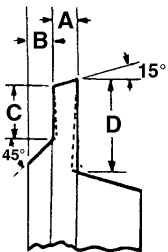

- For cutting-off and chamfering
- **Carbide tipped tools** are supplied for right hand cutting, for left hand cutting add -L to the part number listed. All other choices have a "U" shaped gash for cutting in either direction.
- Side clearance ground
- Available with side pinholes
- Available with 23 degree C/O angle for non-ferrous metals
- Available with TIN and other coatings



CIRCULAR CUT-OFF & CHAMFER TOOLS FOR #0 B&S (1-3/4" DIA., 1/4" WIDE WITH 3/8-16 THREAD)

A	B	C	D	M2 PART#	T15PM PART#	3-LIP C2 CARB. TIPPED PART#
.030	.030	3/64	1/4	00C3	00C3V	00C3-CT
.040	.040	5/64	1/4	00C4	00C4V	00C4-CT
.050	.050	7/64	1/4	00C5	00C5V	00C5-CT
.060	.060	9/64	1/4	00C6	00C6V	00C6-CT
.070	.070	11/64	1/4	00C7	00C7V	00C7-CT
.080	.080	13/64	1/4	00C8	00C8V	00C8-CT

CIRCULAR CUT-OFF & CHAMFER TOOLS FOR #2 B&S (3" DIA., 3/8" WIDE WITH 5/8-11 THREAD)

A	B	C	D	M2 PART#	T15PM PART#	3-LIP C2 CARB. TIPPED PART#
.060	.060	1/8	3/8	2C6	2C6V	2C6-CT
.070	.070	3/16	7/16	2C7	2C7V	2C7-CT
.080	.080	1/4	1/2	2C8	2C8V	2C8-CT
.090	.090	5/16	9/16	2C9	2C9V	2C9-CT
.100	.100	3/8	9/16	2C10	2C10V	2C10-CT
.110	.110	7/16	5/8	2C11	2C11V	2C11-CT
.120	.120	1/2	5/8	2C12	2C12V	2C12-CT
.140	.140	9/16	11/16	2C14	2C14V	2C14-CT

CIRCULAR CUT-OFF & CHAMFER TOOLS FOR #0 B&S (2-1/4" DIA., 5/16" WIDE WITH 1/2-13 THREAD)

A	B	C	D	M2 PART#	T15PM PART#	3-LIP C2 CARB. TIPPED PART#
.040	.040	5/64	5/16	0C4	0C4V	0C4-CT
.050	.050	7/64	5/16	0C5	0C5V	0C5-CT
.060	.060	9/64	5/16	0C6	0C6V	0C6-CT
.070	.070	11/64	3/8	0C7	0C7V	0C7-CT
.080	.080	7/32	3/8	0C8	0C8V	0C8-CT
.090	.090	9/32	3/8	0C9	0C9V	0C9-CT
.100	.100	11/32	3/8	0C10	0C10V	0C10-CT

FISHTAIL (TUBING) CUT-OFF TOOLS

Somma can supply any of the above standard tools to "fishtail" shape for cutting tubing. The fishtail shape produces a clean cutoff on both the front and back of the part. It avoids the problem of material being rolled into and closing the front end of the hole.



CIRCULAR CUT-OFF & CHAMFER TOOLS To Your Specifications

Prices on application, specify "A", "B", "C", and "D" dimensions, quantity, machine size, steel and type tool desired.

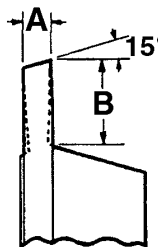

CIRCULAR PLAIN CUT-OFF TOOLS FOR DAVENPORT MACHINES (CAN ALSO BE USED ON 7/16" ACME AND 9/16" CONE MACHINES)

A	B	M2 PART#	T15PM PART#	3-LIP C2 CARB. TIPPED PART#	SOLID C2 CARBIDE PART#
.030	3/32	DP030	DP030V	DP030-CT	
.040	1/8	DP040	DP040V	DP040-CT	
.050	3/16	DP050	DP050V	DP050-CT	DP050-SC
.060	7/32	DP060	DP060V	DP060-CT	
.070	1/4	DP070	DP070V	DP070-CT	DP070-SC
.080	9/32	DP080	DP080V	DP080-CT	
.090	9/32	DP090	DP090V	DP090-CT	DP090-SC



- For straight cutting-off
- Side clearance ground
- All with side pinholes
- Available with 23 degree C/O angle for non-ferrous metals
- Available with TIN and other coatings

"T" CUT-OFF BLADE HOLDER FOR DAVENPORT

This Cut-Off Blade Holder can be mounted in the circular form tool position on the Davenport Machine and holds standard 1/2" high "T" Type Cut-Off Blades.

Cat. No.
TCOBH-DAV

EXCLUSIVE ADJUSTMENT FEATURE
MAKES COMPENSATION FOR
DIFFERENT BLADE WIDTHS FAST AND
EASY

- * ELIMINATES NEED FOR WASHERS OR SPACERS
- * HOLDS BLADES MORE SECURELY
- * HOLDER LASTS LONGER

(FOR STANDARD BLADES TO FIT THIS HOLDER SEE PAGES 47 & 48).

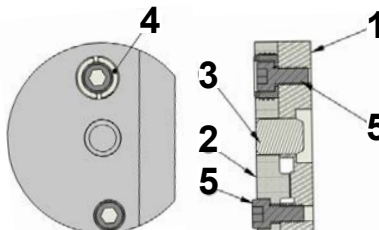

Part No.	Cat. No.
1. Body	TCOBH-DAV-1
2. Clamp	TCOBH-DAV-2
3. Adjustment Screw	TCOBH-DAV-3
4. Center Stud	TCOBH-DAV-4
5. Clamp Screws	ATTO-16

CUT-OFF BLADE HOLDERS

- Fits R & L Universal Tool Post
- Can also be used on turret lathe tool posts
- Forward rotation holder can be used on either front or rear side.
- Reverse rotation holder can be used on either front or rear side
- Entire holder can be removed for tool resharping without losing setting.
- TCOBH-ACCU is rectangular and does not have projection "C" and "E".



HOLDERS FOR T-TYPE BLADES

TOOL NO.	ROTATION	BLADE HEIGHT
TCOBH00-F	FORWARD	1/2
TCOBH00-R	REVERSE	1/2
TCOBH1-F	FORWARD	11/16
TCOBH1-R	REVERSE	11/16
TCOBH2-F	FORWARD	11/16
TCOBH2-R	REVERSE	11/16
TCOBH-ACCU	FORWARD	1/2

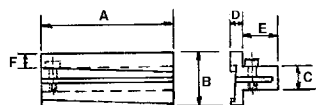

CUT-OFF BLADE HOLDER SPECIFICATIONS

Size	A	B	C	D	E	F
No. 00	2-1/2	1"	3/8	1/4	1/2	5/16
No. 1	2-3/4	1-1/8	1/2	1/4	3/4	9/32
No. 2	3"	1-3/16	5/8	5/16	1"	5/16
ACCU	3-1/2	63/64	0	9/16	0	1/4

(FOR STANDARD CUT-OFF BLADES TO FIT THESE HOLDERS SEE PAGES 48 & 49.)

UNIVERSAL CUT-OFF BLADE TOOL POST FOR B&S MACHINES

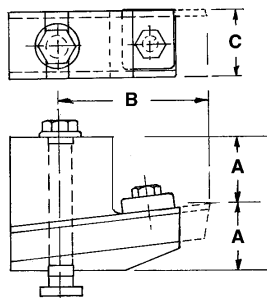

UNIQUE DESIGN:

- ONE TOOL POST TAKES CARE OF ALL POSITIONS BY HOLDING BLADE ON ONE SIDE OR THE OTHER AND BY USING TOOL POST RIGHT SIDE UP OR UPSIDE DOWN
- CAN BE USED ON EITHER FRONT OR REAR SLIDE AND FOR FORWARD OR REVERSE ROTATION
- HOLDS "T" TYPE CUTOFF BLADES (SEE PAGES 6 & 7 FOR BLADES TO FIT THESE HOLDERS)
- RUGGED CONSTRUCTION
- REVERSIBLE CLAMP BLOCK HOLDS BLADE SECURELY ON EITHER SIDE

CAT. NO.	A	B	C	BLADE
BLTP-00	1"	2-3/16	1"	1/2
BLTP-0	1-5/16	2-3/4	1-1/4	11/16
BLTP-2	1-7/16	3-5/8	1-3/8	11/16



- Ground all over
- Concave ground top
- Blade centered

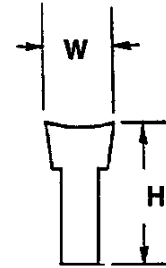

- M2** - GENERAL PURPOSE WITH EXCELLENT TOUGHNESS
COBALT- HIGHEST HEAT RESISTANCE, HIGHER RPM APPLICATIONS
T15PM - EXCELLENT FOR DIFFICULT TO MACHINE MATERIALS WITH GOOD HEAT RESISTANCE

REF#	SIZE			M2 STEEL ORDERING#	COBALT STEEL ORDERING#	T15PM STEEL ORDERING#
	W	H	L			
P1N	.040	1/2	3-1/2	TBL332	TBL332C	TBL332V
P1	1/16	1/2	4-1/2	TBL432	TBL432C	TBL432V
P2N	5/64	1/2	4-1/2	TBL532	TBL532C	TBL532V
P2	3/32	1/2	4-1/2	TBL632	TBL632C	TBL632V
P3S	1/8	1/2	4-1/2	TBL832	TBL832C	TBL832V
P3N-866	1/16	11/16	5	TBL444	TBL444C	TBL444V
	5/64	11/16	5	TBL544	TBL544C	TBL544V
P3N	3/32	11/16	5	TBL644	TBL644C	TBL644V
P3	1/8	11/16	5	TBL844	TBL844C	TBL844V
P4	5/32	11/16	5	TBL1044	TBL1044C	TBL1044V
P5S	3/16	11/16	5	TBL1244	TBL1244C	TBL1244V
P3W	1/8	3/4	5	TBL848	TBL848C	TBL848V
P4W	5/32	3/4	5	TBL1048	TBL1048C	TBL1048V
P5W	3/16	3/4	5	TBL1248	TBL1248C	TBL1248V
P5X-931	3/32	7/8	6	-	TBL656C	TBL656V
P5X	1/8	7/8	6	TBL856	TBL856C	TBL856V
P5N	5/32	7/8	6	TBL1056	TBL1056C	TBL1056V
P5	3/16	7/8	6	TBL1256	TBL1256C	TBL1256V
P6	1/4	7/8	6	TBL1656	TBL1656C	TBL1656V
P8X	1/8	1-1/8	6-1/2	TBL872	TBL872C	TBL872V
P8N	5/32	1-1/8	6-1/2	TBL1072	TBL1072C	TBL1072V
P8	3/16	1-1/8	6-1/2	TBL1272	TBL1272C	TBL1272V
P9	1/4	1-1/8	6-1/2	TBL1672	TBL1672C	TBL1672V
P10	5/16	1-1/8	6-1/2	TBL2072	TBL2072C	TBL2072V

H.S.S. CUT-OFF BLADE GRINDING OPTIONS:

(FOR THE OPTIONS LISTED, ADD THE SUFFIX LISTED BELOW TO THE ORDERING NUMBER)

- CB = CHIP BREAKER GROOVE GROUND ALONG THE TOP LENGTH OF THE BLADE
- TAPER = SIDE TAPER GROUND FRONT TO BACK ALONG T PORTION OF BLADE

CUT-OFF BLADE COATING OPTIONS:

(FOR THE OPTIONS LISTED, ADD THE SUFFIX LISTED BELOW TO THE ORDERING NUMBER)

- TIN A GOOD GENERAL PURPOSE COATING FOR METAL CUTTING
- TICN THIS COATING IS RECOMMENDED FOR MACHINING HIGH CARBON STEEL, HIGH SILICON ALUMINUMS AND TOOL STEELS
- TIALN FOR MACHINING CAST IRON, HIGH NICKEL AND TITANIUM ALLOYS, HARDENED STEELS AND STAINLESS STEELS. GOOD CHOICE FOR INTERRUPTED APPLICATIONS

*****MANY MORE SPECIALIZED COATINGS AVAILABLE*****

SOLID CARBIDE T-TYPE C/O BLADES ON PAGE 50

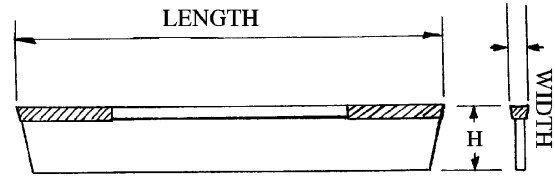

MICROGRAIN - INCREASED FEEDS, SHOCK RESISTANT FOR INTERRUPTED CUTS.
C2 CARBIDE - HEAT AND WEAR RESISTANT. FOR CAST IRON & NON-FERROUS METALS AND PLASTICS.
C6 CARBIDE - FOR CARBON AND ALLOY STEELS AT MEDIUM SPEEDS. CAN BE USED AT HIGHER FEED RATES THAN C2.

REF#	W	SIZE H	L	DOUBLE END MICROGRAIN ORDERING#	SINGLE END C2 ORDERING#	DOUBLE END C6 ORDERING#	SINGLE END C6 ORDERING#
P1N	.040	1/2	3-1/2	CTBL332-MIC	CTBL332-C2-SE	CTBL332-C6	CTBL332-C6-SE
P1	1/16	1/2	4-1/2	CTBL432-MIC	CTBL432-C2-SE	CTBL432-C6	CTBL432-C6-SE
P2N	5/64	1/2	4-1/2	CTBL532-MIC	CTBL532-C2-SE	CTBL532-C6	CTBL532-C6-SE
P2	3/32	1/2	4-1/2	CTBL632-MIC	CTBL632-C2-SE	CTBL632-C6	CTBL632-C6-SE
P3S	1/8	1/2	4-1/2	CTBL832-MIC	CTBL832-C2-SE	CTBL832-C6	CTBL832-C6-SE
P3N-866	1/16	11/16	5	CTBL444-MIC	CTBL444-C2-SE	CTBL444-C6	CTBL444-C6-SE
	5/64	11/16	5	CTBL544-MIC	CTBL544-C2-SE	CTBL544-C6	CTBL544-C6-SE
P3N	3/32	11/16	5	CTBL644-MIC	CTBL644-C2-SE	CTBL644-C6	CTBL644-C6-SE
P3	1/8	11/16	5	CTBL844-MIC	CTBL844-C2-SE	CTBL844-C6	CTBL844-C6-SE
P4	5/32	11/16	5	CTBL1044-MIC	CTBL1044-C2-SE	CTBL1044-C6	CTBL1044-C6-SE
P5S	3/16	11/16	5	CTBL1244-MIC	CTBL1244-C2-SE	CTBL1244-C6	CTBL1244-C6-SE
P3W	1/8	3/4	5	CTBL848-MIC	CTBL848-C2-SE	CTBL848-C6	CTBL848-C6-SE
P4W	5/32	3/4	5	CTBL1048-MIC	CTBL1048-C2-SE	CTBL1048-C6	CTBL1048-C6-SE
P5W	3/16	3/4	5	CTBL1248-MIC	CTBL1248-C2-SE	CTBL1248-C6	CTBL1248-C6-SE
P5X-931	3/32	7/8	6	CTBL656-MIC	-	-	-
P5X	1/8	7/8	6	CTBL856-MIC	CTBL856-C2-SE	CTBL856-C6	CTBL856-C6-SE
P5N	5/32	7/8	6	CTBL1056-MIC	CTBL1056-C2-SE	CTBL1056-C6	CTBL1056-C6-SE
P5	3/16	7/8	6	CTBL1256-MIC	CTBL1256-C2-SE	CTBL1256-C6	CTBL1256-C6-SE
P6	1/4	7/8	6	CTBL1656-MIC	CTBL1656-C2-SE	CTBL1656-C6	CTBL1656-C6-SE
P8X	1/8	1-1/8	6-1/2	CTBL872-MIC	CTBL872-C2-SE	CTBL872-C6	CTBL872-C6-SE
P8N	5/32	1-1/8	6-1/2	CTBL1072-MIC	CTBL1072-C2-SE	CTBL1072-C6	CTBL1072-C6-SE
P8	3/16	1-1/8	6-1/2	CTBL1272-MIC	CTBL1272-C2-SE	CTBL1272-C6	CTBL1272-C6-SE
P9	1/4	1-1/8	6-1/2	CTBL1672-MIC	CTBL1672-C2-SE	CTBL1672-C6	CTBL1672-C6-SE
P10	5/16	1-1/8	6-1/2	CTBL2072-MIC	CTBL2072-C2-SE	CTBL2072-C6	CTBL2072-C6-SE

CUT-OFF BLADE COATING OPTIONS:

(FOR THE OPTIONS LISTED, ADD THE SUFFIX LISTED BELOW TO THE ORDERING NUMBER)

- TIN A GOOD GENERAL PURPOSE COATING FOR METAL CUTTING
- TICN THIS COATING IS RECOMMENDED FOR MACHING HIGH CARBON STEEL, HIGH SILICON ALUMINUMS AND TOOL STEELS
- TIALN FOR MACHING CAST IRON, HIGH NICKEL AND TITANIUM ALLOYS, HARDENED STEELS AND STAINLESS STEELS. GOOD CHOICE FOR INTERRUPTED APPLICATIONS

*****MANY MORE SPECIALIZED COATINGS AVAILABLE*****

MICRO-GRAIN CARBIDE TIPPED / SHORT LENGTH T-TYPE CUT-OFF BLADES

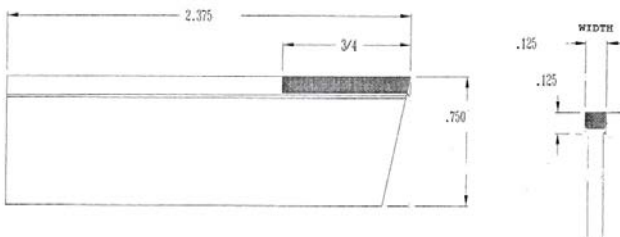

CAT. NO.	WIDTH	HEIGHT	LENGTH	"A"
CTBL848-MIC-2-3/8	1/8	3/4	2-3/8"	3/4
CTBL1048-MIC-2-3/8	5/32	3/4	2-3/8"	3/4
CTBL1248-MIC-2-3/8	3/16	3/4	2-3/8"	3/4

SOLID CARBIDE T-TYPE C/O BLADES ON NEXT PAGE

SOLID CARBIDE T-TYPE CUT-OFF BLADES

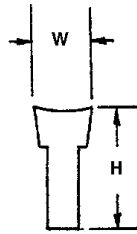

Tools are supplied ready for use with cut-off angles sharpened on both ends so that tools can be used on front or rear slide and for either right or left hand operations.

CAT NO.	W	H	LENGTH	REF. NO.
SCBL332	3/64	1/2	4"	P-1-N
SCBL432	1/16	1/2	4"	P-1
SCBL532	5/64	1/2	4"	P-2-N
SCBL632	3/32	1/2	4"	P-2
SCBL832	1/8	1/2	4"	P-3-S
SCBL444	1/16	11/16	4"	P-3N-866
SCBL644	3/32	11/16	4"	P-3-N
SCBL844	1/8	11/16	4"	P-3
SCBL1244	3/16	11/16	4"	P-5-S

LOW COST!
MORE PIECES PER BLADE!
 Longer wear, less galling, better finish,
 higher speeds than high-speed steels.
PLUS greater rigidity and up to 10 times the
 resharpenable tool life of carbide tipped tools.

CUT-OFF BLADE COATING OPTIONS:

(FOR THE OPTIONS LISTED, ADD THE SUFFIX LISTED BELOW TO THE ORDERING NUMBER)

- TIN A GOOD GENERAL PURPOSE COATING FOR METAL CUTTING
- TICN THIS COATING IS RECOMMENDED FOR MACHINING HIGH CARBON STEEL, HIGH SILICON ALUMINUMS AND TOOL STEELS
- TIALN FOR MACHINING CAST IRON, HIGH NICKEL AND TITANIUM ALLOYS, HARDENED STEELS AND STAINLESS STEELS. GOOD CHOICE FOR INTERRUPTED APPLICATIONS

CUT OFF

EMPIRE® TWIN-TIP® STYLE CUT-OFF BLADES

Call Somma Tool for a quote!

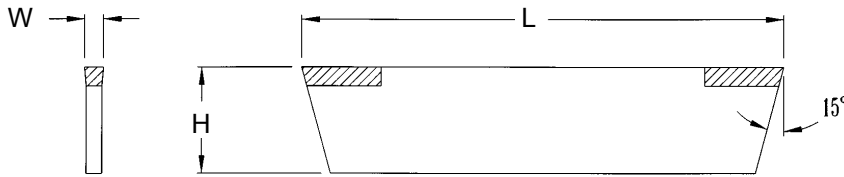

Specify either the complete Empire® part number or the following:

- 1) Height, Width, and Length
- 2) Front C/O Angle (Ex. 4° left angle)
- 3) Carbide Grade (Ex. C2)
- 4) Coating Type (if applicable)

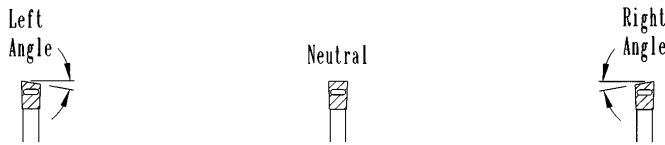

ACME "B" TYPE CUT-OFF BLADES 7° BEVELED



W	H	L	REF. NO	T15PM H.S.S CAT. NO.	MICRO-GRAIN CARBIDE TIPPED CAT. NO.
.040	1/2	5-3/4	B-17	ABL332V	ABL332-MIC
1/16	1/2	5-3/4	B-1	ABL432V	ABL432-MIC
3/32	1/2	5-3/4	B-2	ABL632V	ABL632-MIC
1/8	1/2	5-3/4	B-5	ABL832V	ABL832-MIC
3/32	13/16	7-3/16	B-3	ABL652V	ABL652-MIC
1/8	13/16	7-3/16	B-6	ABL852V	ABL852-MIC
5/32	13/16	7-3/16	B-8	ABL1052V	ABL1052-MIC
3/16	13/16	7-3/16	B-9	ABL1252V	ABL1252-MIC
1/4	13/16	7-3/16	B-11	ABL1652V	ABL1652-MIC
1/8	1"	8-1/4	B-7	ABL864V	ABL864-MIC
3/16	1"	8-1/4	B-10	ABL1264V	ABL1264-MIC
1/4	1"	8-1/4	B-12	ABL1664V	ABL1664-MIC
1/4	1-1/4	9"	B-13	ABL1680V	ABL1680-MIC

JCO (JOHNSON STYLE) HOLLOW GROUND CUT-OFF BLADES - H.S.S.

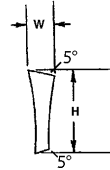

CUT-OFF ANGLE HAS TO BE SHARPENED BEFORE USING TO SUIT INDIVIDUAL APPLICATION.

- Ground all over

- M2** - GENERAL PURPOSE WITH EXCELLENT TOUGHNESS
- COBALT-** HIGHEST HEAT RESISTANCE, HIGHER RPM APPLICATIONS
- T15PM** - EXCELLENT FOR DIFFICULT TO MACHINE MATERIALS WITH GOOD HEAT RESISTANCE

W	H	L	M2 STEEL ORDERING#	COBALT STEEL ORDERING#	T15PM STEEL ORDERING#
.035	1/2	4-1/2	BL232	--	--
3/64	1/2	4-1/2	BL332	BL332C	BL332V
1/16	1/2	4-1/2	BL432	BL432C	BL432V
5/64	1/2	4-1/2	BL532	BL532C	BL532V
3/32	1/2	4-1/2	BL632	BL632C	BL632V
1/8	1/2	4-1/2	BL832	BL832C	BL832V
3/64	11/16	5"	--	--	BL344V
1/16	11/16	5"	BL444	BL444C	BL444V
3/32	11/16	5"	BL644	BL644C	BL644V
1/8	11/16	5"	BL844	BL844C	BL844V
5/32	11/16	5"	BL1044	BL1044C	BL1044V
3/16	11/16	5"	BL1244	BL1244C	BL1244V
1/4	11/16	5"	BL1644	BL1644C	BL1644V
1/16	13/16	6"	BL452	BL452C	BL452V
3/32	13/16	6"	BL652	BL652C	BL652V
1/8	13/16	6"	BL852	BL852C	BL852V
5/32	13/16	6"	BL1052	BL1052C	BL1052V
3/16	13/16	6"	BL1252	BL1252C	BL1252V
1/4	13/16	6"	BL1652	BL1652C	BL1652V

CUT-OFF BLADE COATING OPTIONS:

(FOR THE OPTIONS LISTED, ADD THE SUFFIX LISTED BELOW TO THE ORDERING NUMBER)

- TIN** A GOOD GENERAL PURPOSE COATING FOR METAL CUTTING
- TICN** THIS COATING IS RECOMMENDED FOR MACHINING HIGH CARBON STEEL, HIGH SILICON ALUMINUMS AND TOOL STEELS
- TIALN** FOR MACHINING CAST IRON, HIGH NICKEL AND TITANIUM ALLOYS, HARDENED STEELS AND STAINLESS STEELS. GOOD CHOICE FOR INTERRUPTED APPLICATIONS

JCO (JOHNSON STYLE) HOLLOW GROUND CUT-OFF BLADES - CARBIDE TIPPED

MICROGRAIN CARBIDE- INCREASED FEEDS, SHOCK RESISTANT FOR INTERRUPTED CUTS.

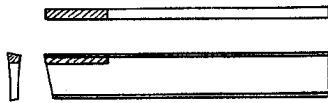

STYLE "Y"
FOR USE ON: FRONT SLIDE
R.H. / REAR SLIDE R.H. OR
VERTICAL SLIDE L.H.

CUT-OFF ANGLE HAS TO BE SHARPENED BEFORE USING TO SUIT INDIVIDUAL APPLICATION.

STYLE "Y" ORDERING#	W	H	L	STYLE "X" ORDERING#
CHBL432-Y-MIC	1/16	1/2	4-1/2	CHBL432-X-MIC
CHBL532-Y-MIC	5/64	1/2	4-1/2	CHBL532-X-MIC
CHBL632-Y-MIC	3/32	1/2	4-1/2	CHBL632-X-MIC
CHBL832-Y-MIC	1/8	1/2	4-1/2	CHBL832-X-MIC
CHBL444-Y-MIC	1/16	11/16	5"	CHBL444-X-MIC
CHBL644-Y-MIC	3/32	11/16	5"	CHBL644-X-MIC
CHBL844-Y-MIC	1/8	11/16	5"	CHBL844-X-MIC
CHBL1044-Y-MIC	5/32	11/16	5"	CHBL1044-X-MIC
CHBL1244-Y-MIC	3/16	11/16	5"	CHBL1244-X-MIC
CHBL452-Y-MIC	1/16	13/16	6"	CHBL452-X-MIC
CHBL652-Y-MIC	3/32	13/16	6"	CHBL652-X-MIC
CHBL852-Y-MIC	1/8	13/16	6"	CHBL852-X-MIC
CHBL1052-Y-MIC	5/32	13/16	6"	CHBL1052-X-MIC
CHBL1252-Y-MIC	3/16	13/16	6"	CHBL1252-X-MIC
CHBL1652-Y-MIC	1/4	13/16	6"	CHBL1652-X-MIC

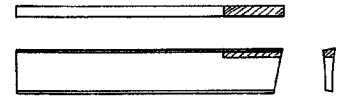

STYLE "X"
FOR USE ON: FRONT SLIDE
L.H. / REAR SLIDE L.H. OR
VERTICAL SLIDE R.H.

ACME CUT-OFF TOOLHOLDERS

Patent No. D307859

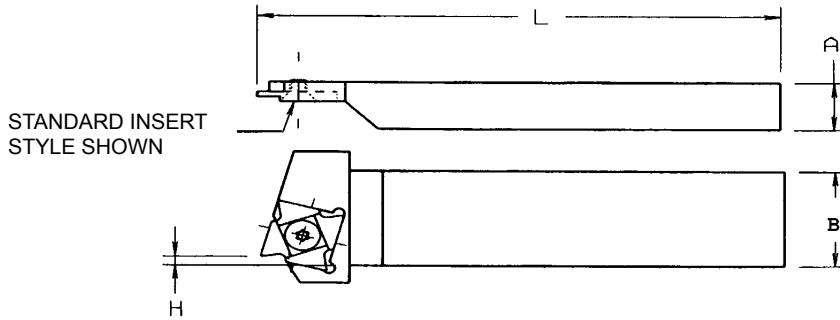

MACHINE SIZE	A	B	H	L	CAT# FOR TOOL HOLDER W/ POCKET FOR 3/4" SQ STANDARD INSERT	CAT# FOR TOOL HOLDER W/ POCKET FOR 1" SQ STANDARD INSERT
7/16" R/A	1.215	0.988	0.251	6.00"	7/16AC-CIN	7/16AC-CIN-EX
9/16" R/A	0.595	1.188	0.251	5.00"	9/16AC-CIN	9/16AC-CIN-EX
1-1/4" R/A	0.845	1.781	0.453	5.00"	1-1/4AC-CIN	1-1/4AC-CIN-EX
1-5/8" R/A	1.235	1.875	0.485	6.00"	1-5/8AC-CIN	1-5/8AC-CIN-EX
2" R/A	1.235	2.250	0.407	6.00"	2AC-CIN	2AC-CIN-EX
3" R/A	1.484	2.500	0.219	6.00"	3AC-CIN	3AC-CIN-EX

INSERT SIZE	INSERT SCREW#	INSERT WRENCH#
3/4" SQ	DAV-CIN-SCR	DAV-CIN-WR
1" SQ	DAV-CIN-SCR-ISO	DAV-CIN-WR

See Page 54 for inserts.

NEW BRITAIN CUT-OFF TOOLHOLDERS

TOOLHOLDERS SHOWN USE .750 SQ INSERT

Patent No. D307859

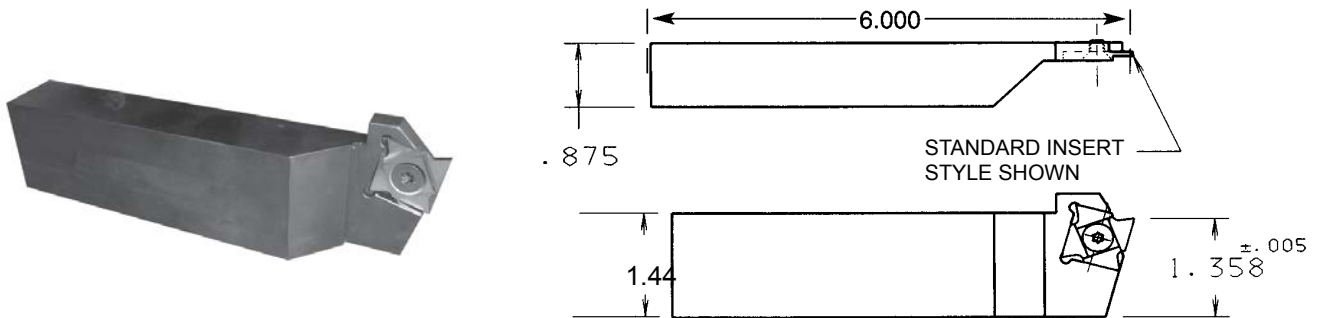

TOOLHOLDER CAT. #	INSERT SIZE	INSERT SCREW	INSERT WRENCH
NB-CIN	3/4"	DAV-CIN-SCR	DAV-CIN-WR
NB-CIN-EX	1"	DAV-CIN-SCR-ISO	DAV-CIN-WR

See Page 54 for inserts.

TOOLHOLDERS SHOWN USE .750 SQ INSERT
Patent No. D307859

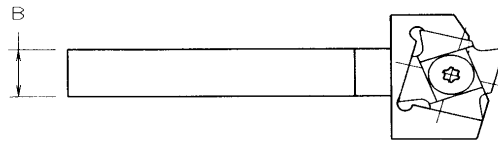

STANDARD STYLE INSERT

STYLE "R" INSERT

STYLE "C" INSERT

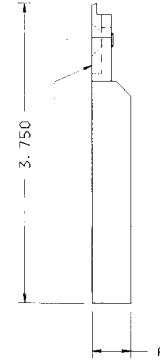
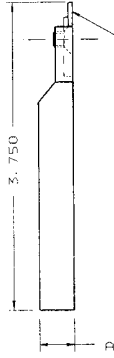
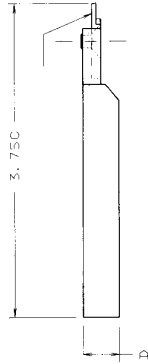

A	B	CAT# FOR STANDARD TOOLHOLDER	CAT# FOR STYLE R TOOLHOLDER	CAT# FOR STYLE C TOOLHOLDER
0.312	0.312	STCC-2117	STCC-2117R	STCC-2117C
0.375	0.375	STCC-2333	STCC-2333R	STCC-2333C
0.500	0.500	STCC-2237	STCC-2237R	STCC-2237C
0.500	0.625	STCC-1099	STCC-1099R	STCC-1099C
0.750	0.750	STCC-2218	STCC-2218R	STCC-2218C
0.750	1.000	STCC-2220	STCC-2220R	STCC-2220C
8MM	8MM	STCC-1915	STCC-4005R	STCC-4005C
10MM	10MM	STCC-4006	STCC-4006R	STCC-4006C
12MM	12MM	STCC-4007	STCC-4007R	STCC-4007C

See Page 54 for inserts.

CATALOG NUMBER	DESCRIPTION
DAV-CIN-SCR	INSERT SCREW
DAV-CIN-WR	INSERT WRENCH

TOOLHOLDER SHOWN USES 1" SQ INSERT
Patent No. D307859

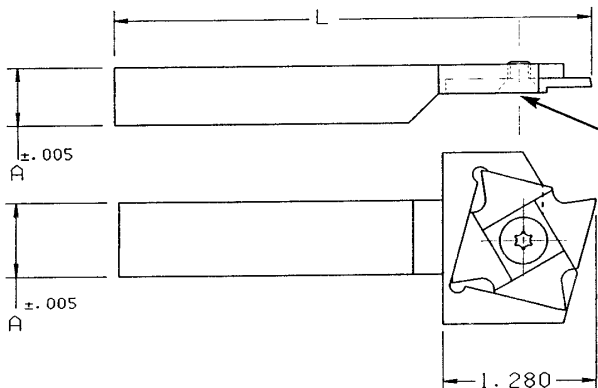

STANDARD INSERT STYLE SHOWN

A	L	CAT# FOR STANDARD TOOLHOLDER
0.500	4"	STCC-4784
0.625	6"	STCC-4785
0.750	6"	STCC-4786
1.000	6"	STCC-4656
12MM	100MM	STCC-4783
16MM	150MM	STCC-4105
20MM	150MM	STCC-6106

See Page 12 for inserts.

CAT#	DESCRIPTION
DAV-CIN-SCR-ISO	INSERT SCREW
DAV-CIN-WR	INSERT WRENCH

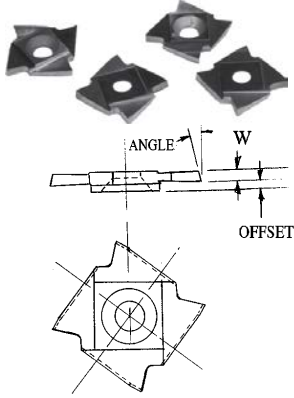

- QUICK CHANGE - JUST ROTATE INSERT WITHOUT REMOVING HOLDER FROM MACHINE (4 USABLE EDGES)
- NEVER LOSES CENTER SETTING - EVEN WHEN CHANGING FROM ONE SIZE CUT-OFF INSERT TO ANOTHER
- FREE CUTTING - INSERTS GROUND WITH BOTH FRONT TO BACK AND TOP TO BOTTOM CLEARANCE - ELIMINATES SIDE RUBBING AND DRAGGING
- LONGER LIFE - MICRO-GRAIN CARBIDE OUTPERFORMS CONVENTIONAL CARBIDE GRADES

CHIP BREAKER TYPE "-CB"

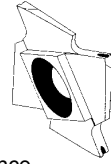

BENEFITS:

- Chip Control
- Ground in chip control for superior performance
- Longer Tool Life
- Minimum Down Time
- Consistent Quality
- Indexes within .001 Inches
- Four Cutting Edges

3/4" SQUARE 8° CUTOFF INSERTS

3/4" SQUARE 0° GROOVING INSERTS

WIDTH C/O	MAX DIA C/O	OFFSET	STD MICRO CARBIDE INSERT CAT. NO	MICRO CARBIDE INSERT W/ CHIP BREAKER CAT#
1/32"	0.187	3/32"	DAV-CIN-2	DAV-CIN-2-CB
1/32"	0.187	0	DAV-CIN-2R	DAV-CIN-2R-CB
3/64"	0.312	5/64"	DAV-CIN-3	DAV-CIN-3-CB
3/64"	0.312	0	DAV-CIN-3R	DAV-CIN-3R-CB
1/16"	0.500	1/16"	DAV-CIN-4	DAV-CIN-4-CB
1/16"	0.500	0	DAV-CIN-4R	DAV-CIN-4R-CB
5/64"	0.562	3/64"	DAV-CIN-5	DAV-CIN-5-CB
5/64"	0.562	0	DAV-CIN-5R	DAV-CIN-5R-CB
3/32"	0.562	1/32"	DAV-CIN-6	DAV-CIN-6-CB
3/32"	0.562	0	DAV-CIN-6R	DAV-CIN-6R-CB
1/8"	0.562	0	DAV-CIN-8	DAV-CIN-8-CB

WIDTH C/O	MAX DIA C/O	OFFSET	STD MICRO CARBIDE INSERT CAT. NO	MICRO CARBIDE INSERT W/ CHIP BREAKER CAT#
1/32"	0.187	3/32"	DAV-CIN-2-0	DAV-CIN-2-0-CB
1/32"	0.187	0	DAV-CIN-2R-0	DAV-CIN-2R-0-CB
3/64"	0.312	5/64"	DAV-CIN-3-0	DAV-CIN-3-0-CB
3/64"	0.312	0	DAV-CIN-3R-0	DAV-CIN-3R-0-CB
1/16"	0.500	1/16"	DAV-CIN-4-0	DAV-CIN-4-0-CB
1/16"	0.500	0	DAV-CIN-4R-0	DAV-CIN-4R-0-CB
5/64"	0.562	3/64"	DAV-CIN-5-0	DAV-CIN-5-0-CB
5/64"	0.562	0	DAV-CIN-5R-0	DAV-CIN-5R-0-CB
3/32"	0.562	1/32"	DAV-CIN-6-0	DAV-CIN-6-0-CB
3/32"	0.562	0	DAV-CIN-6R-0	DAV-CIN-6R-0-CB
1/8"	0.562	0	DAV-CIN-8-0	DAV-CIN-8-0-CB

1" SQUARE 8° CUTOFF INSERTS

WIDTH C/O	MAX DIA C/O	OFFSET	STD MICRO CARBIDE INSERT CAT. NO	MICRO CARBIDE INSERT W/ CHIP BREAKER CAT#
1/16"	0.844	1/16"	2EX-CIN-4	2EX-CIN-4-CB
1/16"	0.844	0	2EX-CIN-4R	2EX-CIN-4R-CB
5/64"	0.844	3/64"	2EX-CIN-5	2EX-CIN-5-CB
5/64"	0.844	0	2EX-CIN-5R	2EX-CIN-5R-CB
3/32"	0.844	1/32"	2EX-CIN-6	2EX-CIN-6-CB
3/32"	0.844	0	2EX-CIN-6R	2EX-CIN-6R-CB
1/8"	0.844	0	2EX-CIN-8	2EX-CIN-8-CB

FOR COATED INSERTS ADD THE FOLLOWING SUFFIXES TO THE PART NUMBERS LISTED:

TIN FOR TITANIUM NITRIDE COATED

TIALN FOR TITANIUM ALUMINUM NITRIDE COATED

TICN FOR TITANIUM CARBO-NITRIDE COATED

PART# DAV-CIN-SCR FOR SCREWS FOR 3/4" SQ INSERTS

PART# DAV-CIN-SCR-ISO FOR SCREWS FOR 1" SQ INSERTS

PART# DAV-CIN-WR FOR INSERT WRENCH

AVAILABLE INSERT STYLES

ADD THE SUFFIX LISTED BELOW TO THE ABOVE CATALOG NUMBERS

COUNTERCLOCKWISE SPINDLE

CLOCKWISE SPINDLE

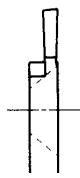

R
(Listed Above)



Standard
(Listed Above)

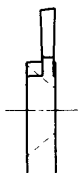

RC

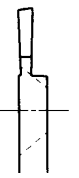

C

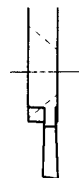

-RA

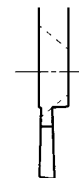

R-RA

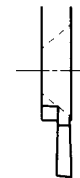

-RAC

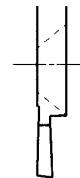

-LH

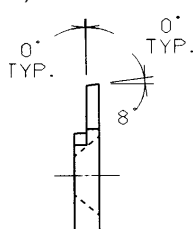

-8-0

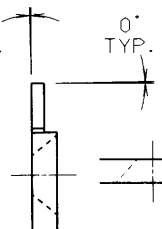

-0-0

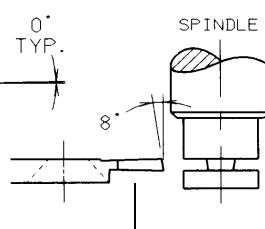

Standard Insert Shown

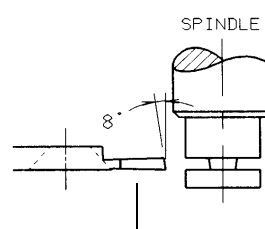

Style R Insert Shown



QUICK CHANGE CARBIDE INSERTED CIRCULAR CUTOFF HOLDERS FOR DAVENPORT 5TH POSITION & B&S MACHINES

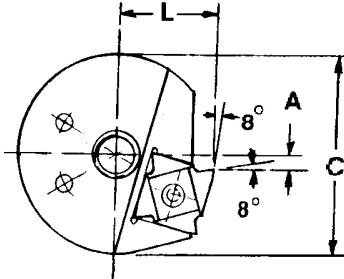

See Page 54 for inserts.

DAVENPORT* W/ TWO 9/64" DIA PINHOLES ON 1-1/4" B.C. & 9/16 REAMED HOLE *ALSO FITS 9/16" CONE & 7/16" ACME				
CAT. NO	INSERT SIZE	A	L	C
DAV-CIN	3/4" SQ	1/8"	1-1/8"	2"
DAV-CIN-EX	1" SQ	1/8"	1-1/8"	2"

#00 B&S & TRAUB W/ TWO 5/32" DIA PINHOLES ON 1-1/16" B.C. AND ONE 1/8" DIA PINHOLE ON .787 B.C.				
CAT. NO	INSERT SIZE	A	L	C
OO-CIN	3/4" SQ	1/8"	1"	1-3/4"

#0 B&S W/ TWO 3/16" DIA PINHOLES ON 1-3/8" B.C.				
CAT. NO	INSERT SIZE	A	L	C
O-CIN	3/4" SQ	5/32"	1-1/8"	2-1/4"

#2 B&S W/ TWO 3/16" DIA PINHOLES ON 1-1/2" B.C.				
CAT. NO	INSERT SIZE	A	L	C
2-CIN	3/4" SQ	1/4"	1-1/2"	3"
2-CIN-EX	1" SQ	1/4"	1-1/2"	3"

For B&S Left Hand holders add **-LH** to the part numbers shown

RESHARPENABLE QUICK CHANGE INSERT CIRCULAR CUTOFF TOOLS FOR 5TH POSITION DAVENPORT

(Patent No. 5,345,846)



Cat. No. RQCDAV-CO

- MOUNTS ON SWING ARM - SAME AS CIRCULAR TOOL.
- ONCE HOLDER IS SET ON CENTER NEVER NEEDS TO BE RESET.
- INSERTS ARE RESHARPENABLE 10 TO 15 TIMES (1/8")..
- INSERTS ALWAYS RETURN TO ORIGINAL DIAMETER AND LENGTH SETTINGS.
- INSERTS CAN BE CHANGED IN LESS THAN A MINUTE.
- INSERTS AVAILABLE TO FULL DIAMETER CAPACITY OF MACHINE.

INSERT RESHARPENING FIXTURE

- For sharpening top surface of inserts
- Flexible jaw clamps insert securely
- For use on surface grinder with cup or dish wheel

Cat. No. RQCSF-CO

MICRO-GRAIN CARBIDE INSERTS

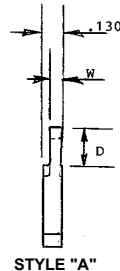

STYLE "A"

BLADE CLOSE TO PICKOFF COLLET

CAT. NO.	STYLE	W*	D
RQCT-047-0	A	.047	3/16
RQCT-063-0	A	.063	5/16
RQCT-078-0	A	.391	25/64
RQCT-094-0	A	.094	7/16
RQCT-125-0	A	.125	9/16

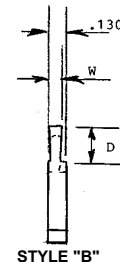

STYLE "B"

BLADE CLOSE TO SPINDLE

CAT. NO.	STYLE	W*	D
RQCT-047	B	.047	3/16
RQCT-063	B	.063	5/16
RQCT-078	B	.391	25/64
RQCT-094	B	.094	7/16

C/O INSERT BLANKS	
FOR REWORK TO YOUR REQUIREMENTS GROUND ON ALL 6 SIDES, 17° ANGLE	
CAT. NO.	MATERIAL
RQCT-MIC	MICROGRAIN CARBIDE
RQCT-A	76PM H/S/S

- PRICES ON APPLICATION FOR WIDER INSERTS FOR PICKOFF COLLET FORM AND CUTOFF WORK.

• NOTE: CUTOFF WIDTH WILL BE REDUCED UP TO .001" PER SIDE (.002" TOTAL) AS INSERT IS RESHARPENED.

Somma

Broaching

Form & Shave

Dovetail Blanks

Cut Off

Swiss Turn

Box Turn

End Working

Knurling

Tapping

Reaming

Drilling

Tool Bushings

Tool Collets

V-Flange Collet Chucks

Endmills

Workholding

and More

Somma
TOOL CO., INC.

109 Scott Road

Waterbury, CT 06705 USA

(203) 753-2114 ■ FAX (203) 756-5489

www.sommatool.com ■ EMAIL sales@sommatool.com

COPYRIGHT © 2017

MADE IN U.S.A.

